

# Installation Instructions for the Honda **VTX 1800** **"SHORTY"**

Thank you for choosing Roadhouse Brand Exhaust pipes. We're confident you will be pleased with your purchase and experience many miles of riding enjoyment. We welcome your comments and opinions on how we can improve our products and services.

**LIMITED ONE YEAR WARRANTY:** Roadhouse Brand guarantees all parts and accessories against defects in material and workmanship. All warranties are pro rated from the date of purchase and will be honored by Roadhouse Brand to the original purchaser only. Merchandise returned under warranty within the first 30 days unused will qualify for a full refund less shipping and handling fees not to exceed \$50.00. Merchandise returned under warranty after 30 days used or unused will be subject to a minimum 15% restocking fee depending on condition and usability of merchandise plus shipping and handling fees. Merchandise returned under warranty after 90 days will be pro-rated from date of purchase and subject to customary restocking and shipping and handling fees. Requesting the return of defective merchandise must be made within the terms of our limited warranty by first contacting Roadhouse Brand for a return authorization claim. Warranty returned merchandise must be accompanied by proof of purchase such as an original invoice, shipped to Roadhouse Brand freight prepaid. Upon inspection and determination of warranty, Roadhouse Brand will replace defective merchandise and return it via UPS ground.

**NOTE:** Discoloration of exhaust pipes is a result of tuning characteristics such as carburetor jetting, overheating, atmospheric and other operating conditions. As a result, it is impossible to guarantee any exhaust system against discoloration of some type. Although Roadhouse Brand has taken careful measures in designing our exhaust pipe to minimize the chance of discoloration, we regret that we are unable to include exhaust pipe discoloration under our warranty coverage.

**CLAIMS:** All goods are carefully inspected and packed when shipped. Title to merchandise passes to customer on delivery from common carrier. Please inspect your merchandise promptly on receipt of goods as to determine responsibility of any damaged merchandise. Delivery of merchandise in good condition is the responsibility of the carrier and all claims for damage or shortage should be made with the carrier immediately.

**RETURNED GOODS:** No return merchandise will be accepted without a return authorization claim from Roadhouse Brand. Return shipment must be sent freight prepaid. An exchange, credit or refund will be issued upon receipt if merchandise is in good useable condition. Any return sent COD will be refused. Proof of purchase, such as original invoice must accompany all returned goods.

**MODIFICATIONS CAUTION:** Be aware that altering your motorcycle in any way may result in impeding your motorcycle's rideability and safety from its original design. It is recommended that you use caution after installing or replacing any accessory as to possible changes handling or operational characteristics that could result in injury.

Roadhouse Brand recommends that you always use caution and exercise safe riding practices when ever you ride a motorcycle. Always wear a helmet and appropriate safety equipment/apparel.

*Please take a few  
moments to read these  
instructions before  
beginning the  
installation*  
**THANKS!**

60 w. Easy St. #6 Simi Valley, CA 93065  
(805) 579-1882 Fx (805)579-1878  
**CUSTOMER SERVICE 888 700-5979**

**Roadhouse**  
TRADEMARK  
**BRAND**



# HONDA VTX 1800 SLIP-ON INSTRUCTIONS

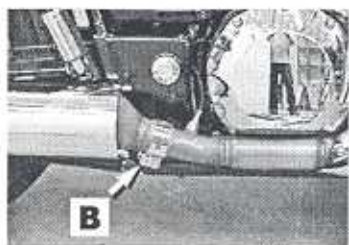
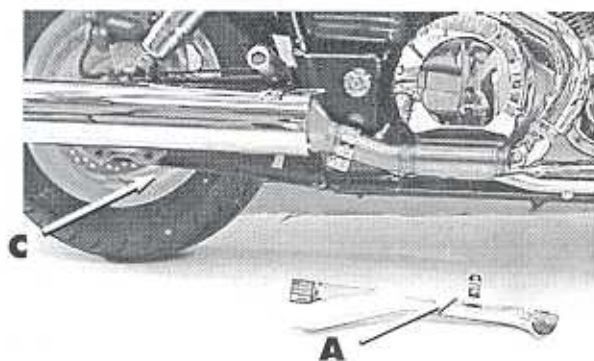

**1).** Remove stock heat shield to expose muffer junction (A) and loosen muffer clamp pinch bolts (B) and Muffer bracket bolts (C). Slip off stock muffer. Remove Carbon mesh gasket.

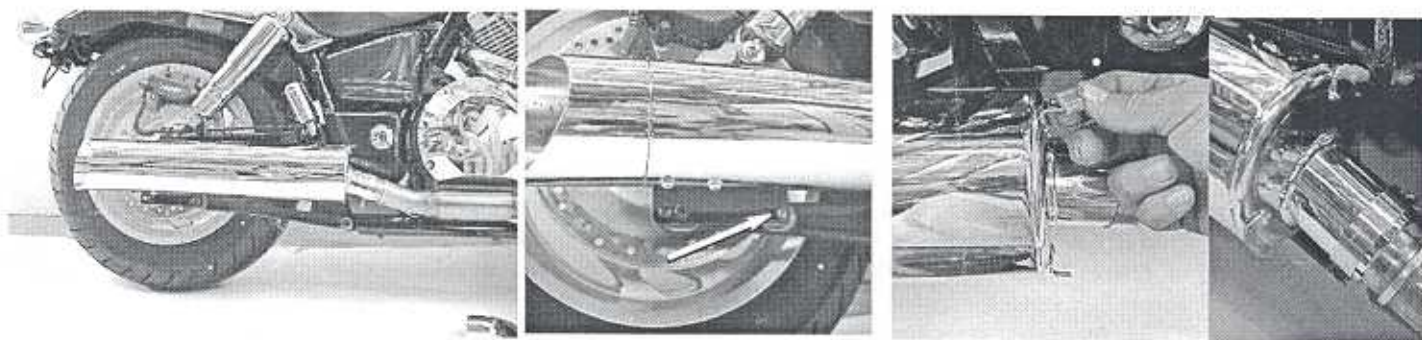

**2).** Slide on Roadhouse muffer with hose clamp in position, install muffer bracket bolts loosely, slide muffer to the rear to allow heat shield installation. Install rubber caps onto front muffer tabs



**3).** Reinstall heat shield with clamp and pinch bolt now slide the muffer forward until bolts are located in center of bracket slots. Tighten hose clamp and muffer bracket bolts and your ready to Rumble!